

SERIES 3000 HYGIENIC CONNECTOR



CHARACTERISTICS

- Available tube sizes: OD6, OD8, OD10
- Thread sizes: G1/8, G1/4, G3/8, M6, M8x1
- Working pressure range: 0 to 145 psi (0 to 10 bar)
- Temperature range: 32 to 266 °F (0 to 130 °C)
- Stainless steel, EPDM/FKM seals
- Recommended Tube: PU (e.g. Eisele ProFood)
- Useable for compressed air applications and cooling water



ADVANTAGES

- Hygienic connector with polished surfaces
- Best cleanability
- FDA compliant seals
- Highest flow rate possible
- Easy installation
- Highest German quality



APPLICATION EXAMPLE

- Simple connection from hygienic areas to non-sensitive areas due to hygienic bulkhead connections

Non-sensitive area

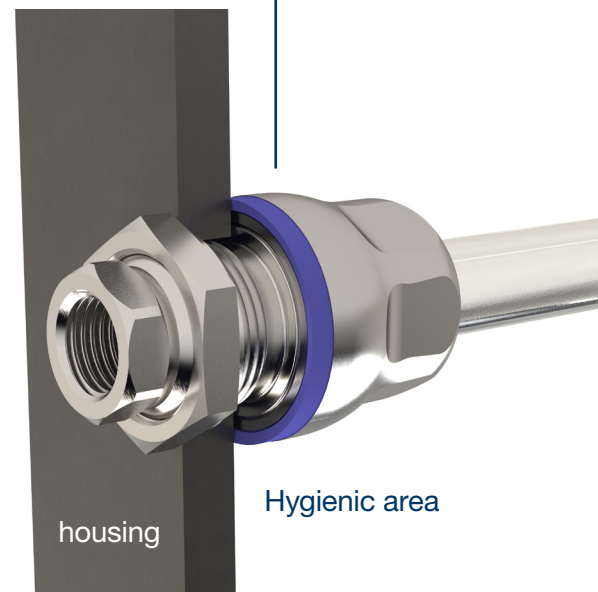

housing

Hygienic area



SERIES 3000

3028 | Straight screw-in connector in hygienic design*



- For increased hygienic requirements
- Withworth pipe thread
- Metal sealing edge
- Seals against penetration of dirt in EPDM, blue | FKM, blue
- Sealing for media in HNBR | FKM
- Material stainless steel AISI 304 external parts 316L | internal parts 304
- Temperature range 32 to 266 °F (0 to 130 °C)
- Working pressure range 0 to 145 psi (0 to 10 bar)
- Useable for compressed air applications and cooling water

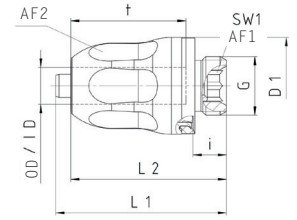

Part no.	Seal	Thread G	for tube OD/ID	AF1	AF2	i	t	L1	L2	D1	ND	g/piece
EPP3028-020406 VTF3028-020406	EPDM (FDA) FKM (FDA)	G1/8	6/4	5	13	5.5	18.8	28	25.5	15.9	3	19
EPP3028-045508 VTF3028-045508	EPDM (FDA) FKM (FDA)	G1/4	8/5.5	6	17	7.5	19.8	31.1	27.4	18.9	4.5	32
EPP3028-060710 VTF3028-060710	EPDM (FDA) FKM (FDA)	G3/8	10/7	8	19	7.5	20.8	32.5	29.8	23.4	6	51

3080 | Bulkhead connector in hygienic design*



- For increased hygienic requirements
- Seals against penetration of dirt in EPDM, blue | FKM, blue
- Sealing for media in HNBR | FKM
- Material stainless steel AISI 304 external parts 316L | internal parts 304
- Temperature range 32 to 266 °F (0 to 130 °C)
- Working pressure range 0 to 145 psi (0 to 10 bar)
- Useable for compressed air applications and cooling water

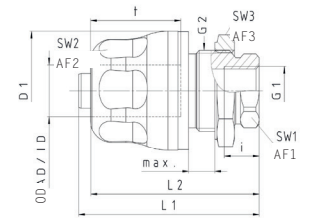

Part no.	Seal	Thread G1	Thread G2	for tube OD/ID	max.	AF1	AF2	AF3	i	t	L1	L2	D1	ND	g/piece
EPP3080-450406 VTF3080-450406	EPDM (FDA) FKM (FDA)	M6	M10x1	6/4	6	8	13	12	5	17	34.4	31.9	15.9	3	23
EPP3080-515508 VTF3080-515508	EPDM (FDA) FKM (FDA)	M8x1	M13x1	8/5.5	6	11	17	15	7	17	38.3	34.6	18.9	4.5	37
EPP3080-010710 VTF3080-010710	EPDM (FDA) FKM (FDA)	G1/8	M16x1	10/7	6	13	19	19	8	20.8	41.5	38.8	23.4	6	62

3080 | Closure screw in hygienic design



- Withworth pipe thread
- Metal sealing edge
- Seals against penetration of dirt in EPDM, blue | FKM, blue
- Material stainless steel AISI 316L
- Temperature range 32 to 266 °F (0 to 130 °C)
- Working pressure range 0 to 145 psi (0 to 10 bar)
- Useable for compressed air applications and cooling water

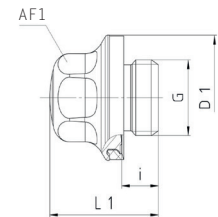

Part no.	Seal	Thread G	AF1	i	L1	D1	g/piece
EPP3023-02 VTF3023-02	EPDM (FDA) FKM (FDA)	G1/8	10	5.5	16.3	15.9	12
EPP3023-04 VTF3023-04	EPDM (FDA) FKM (FDA)	G1/4	13	7.5	19.7	18.9	24
EPP3023-06 VTF3023-06	EPDM (FDA) FKM (FDA)	G3/8	17	7.5	20.9	234	41

*Connection technology also available without spigot with full nominal width
Illustrations not binding, subject to change,
no liability for errors and misprints - 03.24